



### FIRST TIME INSTALLATION

- \* REMOVE PARTS FROM INSIDE THE PACKAGE AND CHECK THEM ALL
- \* CONTACT YOUR DEALER IF ANY PART IS MISSING OR DAMAGED
- \* USE THE EQUIPMENT SPECIFIED FOR INSTALLATION

### ASSEMBLY INSTRUCTIONS (BRACKET KIT)

Product Code: MB05111(A/B TYPE)

### COMPATIBLE VEHICLES

SZX SX4 S-CROSS 14-



### USE OF CN-... PARTS

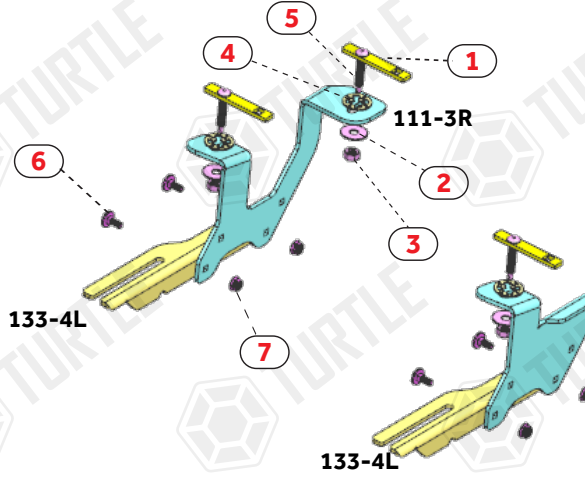
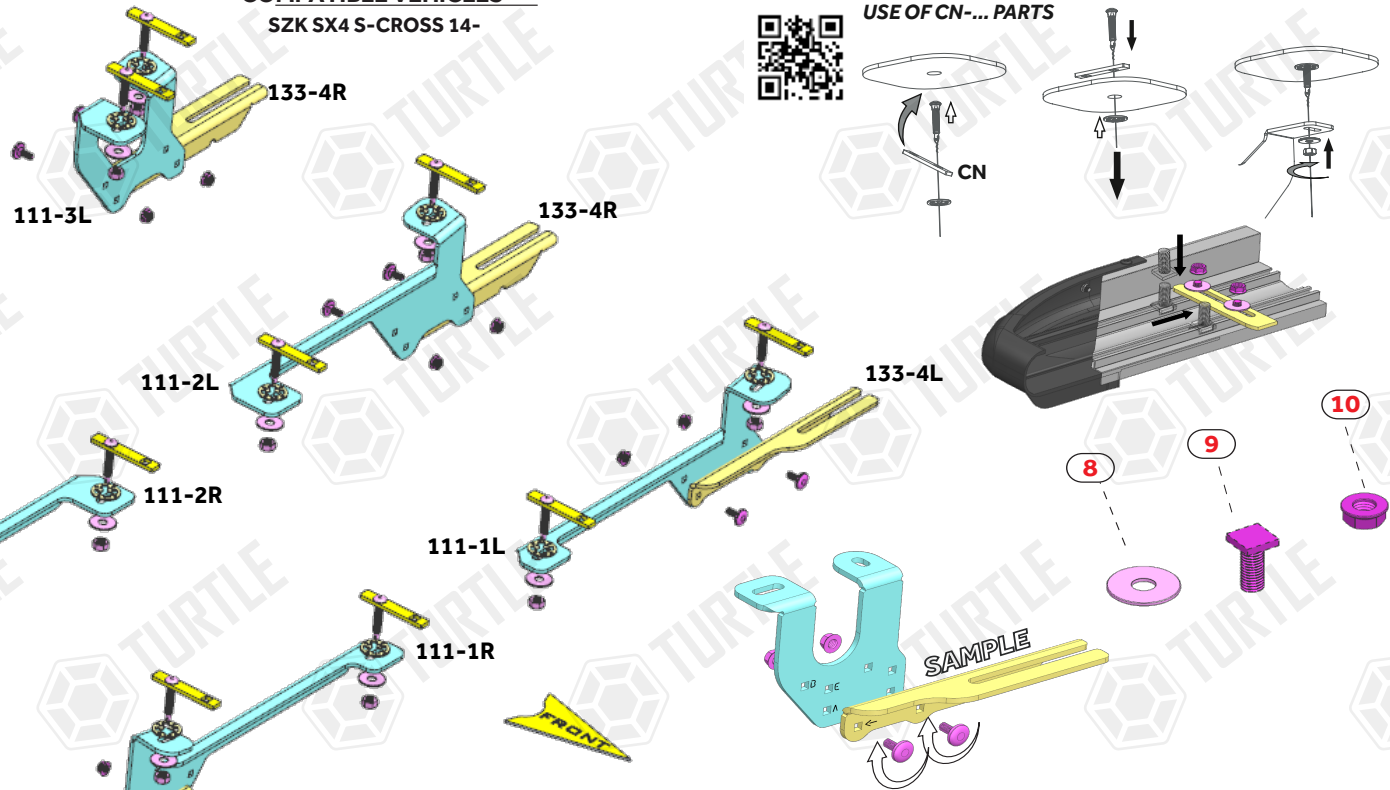
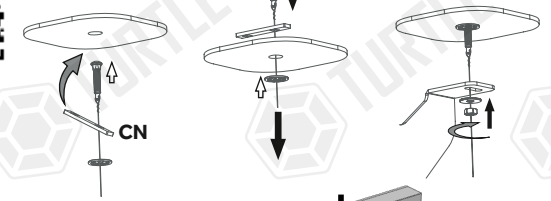

### PACKAGE INCLUDED

1- CN-01 M8	12
2- D8 WASHER	12
3- M8 HEX NUT	12
4- CLAMPING PIECE	12
5- M8 SPECIAL BOLT	12
6- M6x15 LOCK HEADED BOLT	12
7- M6 HEX FLANGE NUT	12
8- D8 WASHER	12
9- M8x20 SQUARE BOLT	12
10- M8 FLANGE NUT	12

ZIPLOCK BAG

Whatever product type you will use, Example of side step types:

Type A (Alyans, Sapphire, Emerald)

Type B (Brillant, Another, Pearl, Ring, Plus) / Type E (Era)

Assemble the parts through the matching fixing holes.

Kullanacağınız ürün tipi hangisi ise, Parçaları ona uyumlu olan bağlantı deliklerinden birleştiriniz.



REAR



MIDDLE



FRONT