



ASSEMBLY INSTRUCTIONS (ROOF RAIL)  
Product Code: MR01065 (Crown)

## FIRST TIME INSTALLATION

- \* REMOVE PARTS FROM INSIDE THE PACKAGE AND CHECK THEM ALL
- \* CONTACT YOUR DEALER IF ANY PART IS MISSING OR DAMAGED
- \* USE THE EQUIPMENT SPECIFIED FOR INSTALLATION

### COMPATIBLE VEHICLES

TYT LCRSR PRD (J120) SUV 02-09  
TYT LCRSR PRD (J150) SUV 10-

### PACKAGE INCLUDED

1-	PLASTIC STOPPLE	4
2-	M8x80 INBUS BOLT (5Nm)	4
3-	M8 1/2 WASHER	4
4-	6mm ALLEN WRENCH	1
5-	10 - 13 WRENCH	1
6-	PLASTIC PART	4
7-	LIQUID RUBBER	1

ZIPLOCK BAG

### Rear Bolt Connection Point

STEP 1

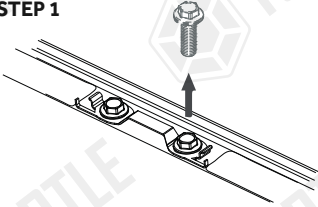

Şekilde belirtilen civatayı sökünüz.  
Unscrew the bolt indicated in the figure.

STEP 2

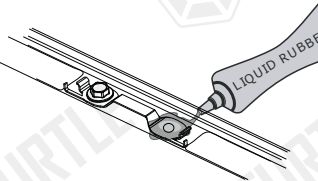

Yalıtım için silikonu yuvanın etrafına bol miktardan sıkınız. Uygulamayı 3dk içerisinde kurumadan tamamlayınız.  
Apply a thick layer of silicone around the hole for insulation. Apply in 3min before silicone dry.

STEP 3

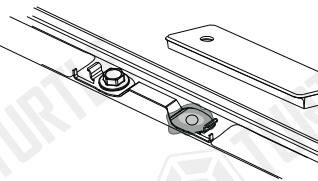

Plastik parçayı şekildeki gibi yerleştiriniz.  
Place the plastic part as shown in the figure.

### Front Bolt Connection Point

STEP 1

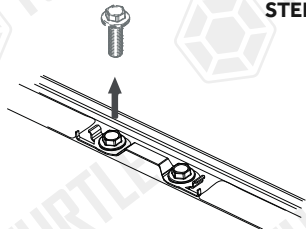

STEP 2

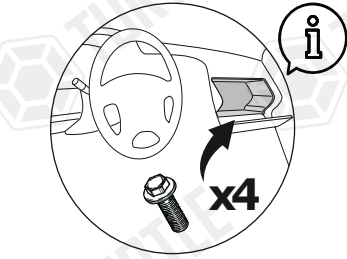
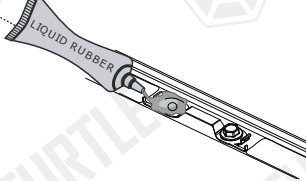

Belirtilen parçaları sökünüz ve saklayınız.  
Remove and keep the specified parts.

STEP 3

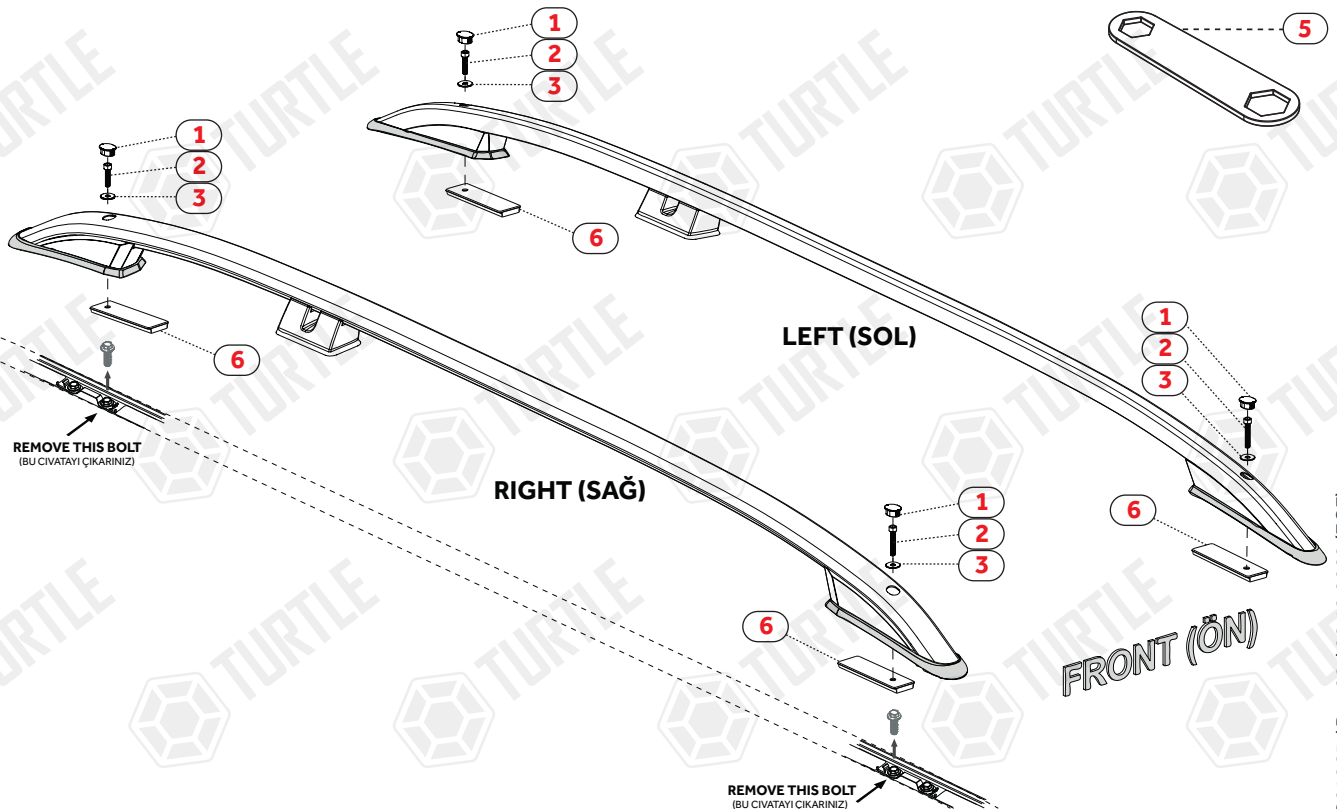
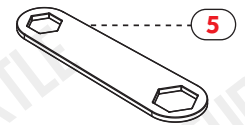
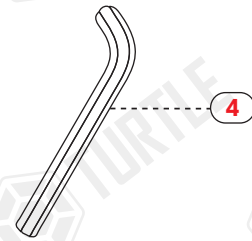
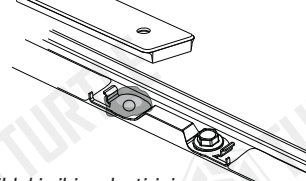

MR01065 / Rev.02 / 08.12.2022 (ECE)